



ASSEMBLY INSTRUCTIONS for Straight Shaft Machines

The assembly is similar to steel blade attachment!

1. Remove original Trimmer Head.

Note: after you have taken off the original Trimmer head you may find a hexagonal or square shafted bolt. This bolt needs to be removed - most of these are left hand thread.

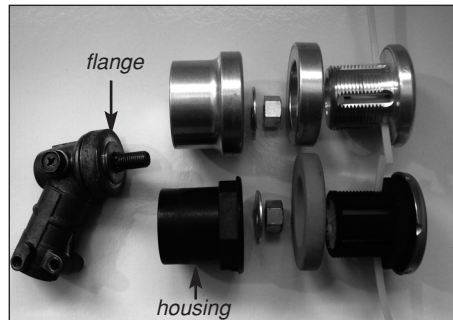
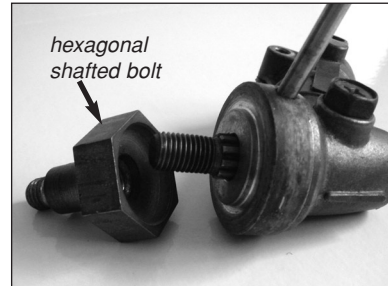

2. Assemble as Illustrated

Unik products are centred by locating the recess (in the back of the Unik housing) over the flange (location guide) on the trimmer.

Note: Your machine may need a different size Nut or you may need a Bolt instead. Please contact us or your local Mower Shop can supply you with the right size Nut or Bolt.

Please call 1300 137 881 if the flange is too small as a spacer may be required.

3. Check tightness after first use.

Note: The white line guide may not be required for cutting line thicker than 3.0mm and can be removed.

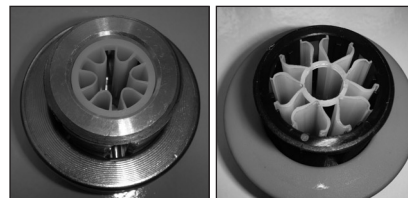

IMPORTANT

Check regularly that the head is clean. Clean with water if necessary. Never attach the head if your brushcutter doesn't have a locating flange (see illustration). Never insert metallic objects: it can damage the guide system. Caution: The number of cutting lines depends of the power of your brushcutter (2, 3, 4 or 6 lines). Listen to the motor of your brushcutter to decide on the number of cutting lines. Use fewer if the motor sounds laboured.

SAFETY WARNING!

- Always wear approved eye protection, helmet and other protective devices to protect yourself when using this trimmer head
- Never operate unit without a debris guard in place
- Keep bystanders at least 15 metres away at all times
- Keep all rotating parts of unit away from your body
- Start work only after checking that there are no objects such as stones, cans or wire around the work site that may be thrown by the cutting head
- Never attempt any maintenance on the trimmer head without first stopping the machine completely

Warranty

We guarantee the assembly and the compatibility of the **Unik** trimmer head (we will refund the purchase cost if the head cannot be adapted to your trimmer). The warranty for the trimmer head itself is for a period of 1 year of normal use.

Please Note: Eurolux Australia is not liable for incorrect assembly or misuse which causes damage or injury. Loading too many lines may cause damage.



EUROLUX AUSTRALIA PTY LTD

PO Box 1335, Mona Vale NSW 1660
Ph (02) 9940 0646 Fax (02) 9940 0645

Email eurolux@eurolux.com.au

Web www.trimmerhead.com.au

ABN 11 091 763 932

Subject to terms & conditions of trade.

**Technical
Assistance
1300 137881**

Dealer	Eurolux Australia
Date of purchase	Month / Year