

Assembly for Straight Shaft Machines

NOTE: These are mostly left hand thread

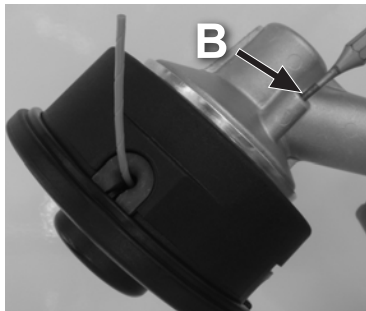

1. Remove original head by locking the spindle with a metal pin (locking point B). Undo your entire head clockwise.

2. If necessary remove hexagonal (or square) bolt (A). Most of these are left hand thread unless it is a bent shaft machine. To stop shaft from turning, lock with a metal pin in the hole (B).

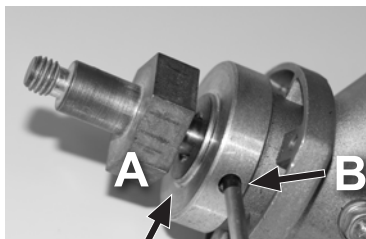

3. The new trimmer head is centred by locating the recess, of the Sure Load over the location flange on your trimmer. (Assembly is similar to steel blade attachment). Use a washer and a Nut/Bolt to secure from the inside. Tighten firmly

Location flange is entering the trimmer head

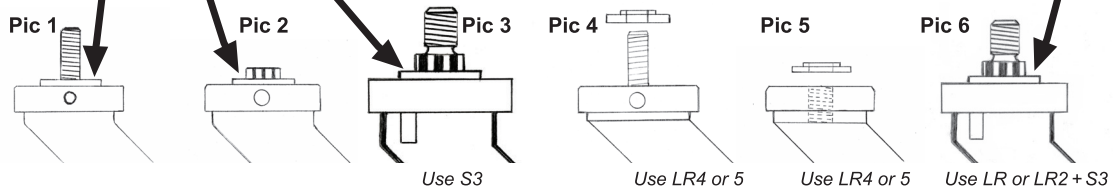
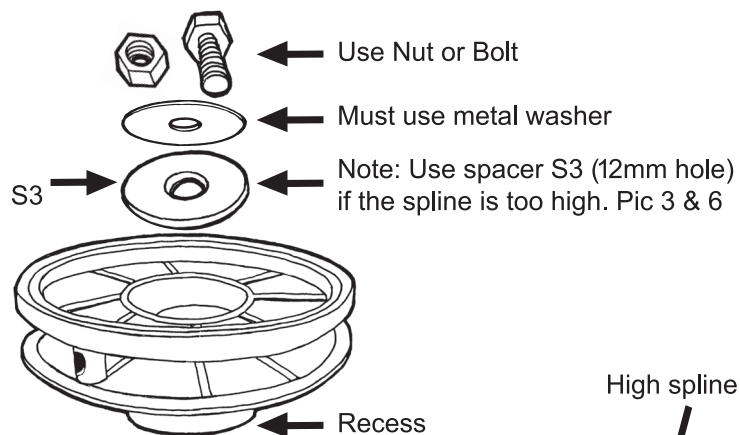

The trimmer head is located on the Location flange. Pic 1-3.
Location ring (LR) may be required if the location point is too small or not built in your machine.



IMPORTANT! You **must** use metal washer & tighten firmly.
See Assembly Video at www.sureload.com.au

Assembly for Bent Shaft Machines

NOTE: This is mostly right hand thread

Remove original head (unscrew entire head or remove bump screw and pull off). Note: Some older Ryobi heads have a retaining clip on the inside of the housing. To remove the housing please split retaining clip first. A chisel or small flat head screwdriver and hammer are best to split the clip. Replacement clips are available from us.



Split retaining clip

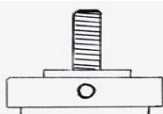

OPTION 1

Your machine has a location flange. Please refer to straight shaft assembly. **Note:** Most bent shaft machines have right hand thread.

OPTION 2

Your machine has a hex shaft. Assemble as shown. Stihl FS 38/45 needs spacer 7 only. Other machines need spacer 6 & 7 together. The Spacer(s) on the inside must sit higher than the shaft on the machine.

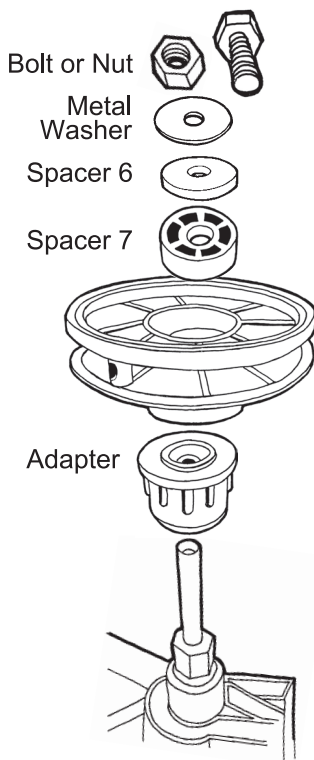

OPTION 3

Your machine has no location flange. Use correct size location ring to locate trimmer head.

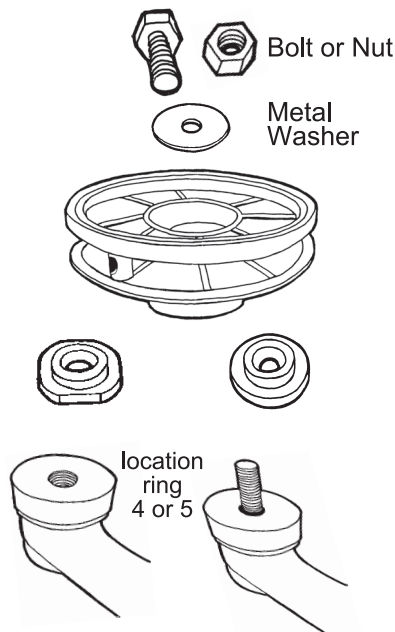

A Universal Adapter Set along with your original equipment should cover all bent shaft trimmers.

Different bolts and nuts are available from your local mower shop, hardware store or from us.

*Email:
info@sureload.com.au*

IMPORTANT! You **must** use metal washer & tighten firmly.

See Assembly Video at www.sureload.com.au